





100  
0 10  
Millimetres

DO NOT SCALE



**Application Boundary**

**2B** Proposed 2 bed houses  
2 storey with 89sqm gross internal area  
8x units on site

**3B** Proposed 3 bed houses  
2 storey with 107 sqm gross internal area  
7x units on site

**▲** Proposed residential access point  
front and rear access to the buildings

**●** Proposed bin storage locations  
small bin stores to accommodate wheelie bins at front of properties

**P** Proposed allocated parking spaces  
2no. parking spaces per plot

**VP** Proposed unallocated (visitor) parking spaces  
3no. visitor parking spaces

**---** Existing combined public sewer  
approx location taken from Severn Trent records

**---** Existing surface water public sewer  
approx location taken from Severn Trent records

**---** Existing surface water private sewer  
approx location taken from Severn Trent records

**---** Sewer easement  
approx location taken from Severn Trent records

**---** Proposed rear garden access  
access provided via garden gates

**---** Proposed SUDS location

**○** Existing Trees

**○** Proposed Trees

**---** Private gardens

**---** Open Green Space

**---** Proposed road crossing point

Scale 1:250

5m 0m 5m 10m 15m

N

P02	12/05/21	Amended planning Issue	DB	EZ	VD
P01	03/12/20	Planning issue	DB	EZ	VD
Rev.	Date	Description	By	CHK'D	App'd

**FOR INFORMATION** **S2**

**ATKINS**  
Member of the SNC-Lavalin Group

The Axis  
10 Holliday Street  
Birmingham  
B1 1TF

Tel: +44 (0)1214 835000  
Fax: +44 (0)1214 835252  
www.atkinsglobal.com

Copyright © Atkins Limited (2021)

Client

Coventry City Council

Project Title

**LAND AT CHELTENHAM CROFT**

Drawing Title

**PROPOSED SITE PLAN**

Scale	Designed	Drawn	Checked	Authorised
1:250	DB	DB	EZ	VD
Original Size	Date	Date	Date	Date
A1	03/12/20	03/12/20	03/12/20	03/12/20
Drawing Number	Revision			
5198676-ATK-XX-XX-DR-AR-091005	P02			

USER: BROWNS2 Date: 12/21 13:56:45  
Filename: P:\GDB\ALICE\2020\Projects\19876\_Land at Cheltenham Croft Coventry\004\_Masterplan\DRG\19876-ATK-XXXX-DR-AR-091005-02\_PROPOSED SITE PLAN.dwg Internal Project Number: 5198676

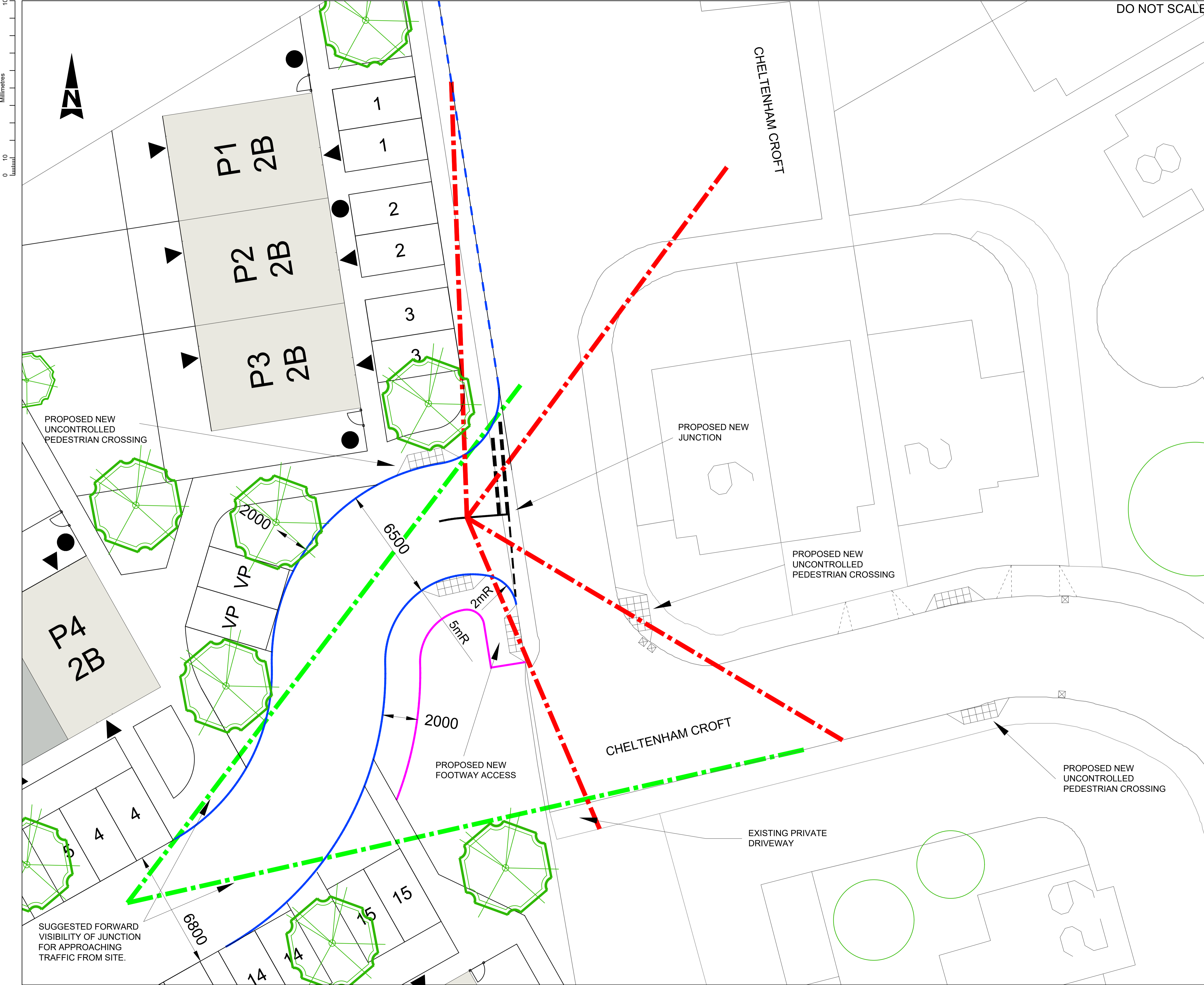

**SAFETY, HEALTH AND ENVIRONMENTAL INFORMATION**  
 In addition to the hazards/risks normally associated with the types of work detailed on this drawing, note the following:

**CONSTRUCTION**  
N/A

**MAINTENANCE/CLEANING**  
N/A

**DECOMMISSIONING/DEMOLITION**  
N/A

It is assumed that all works will be carried out by a competent contractor working, where appropriate, to an approved method statement

**Key**

- NEW FULL FACE PCC KERBS
- NEW DROP KERBS
- NEW FOOTWAY EDGING
- ROAD MARKINGS DIAG. 1003
- ROAD MARKINGS DIAG. 1009
- ROAD MARKINGS DIAG. 1004
- 2.4m x 25m JUNCTION VISIBILITY (Based on 20mph design speed MFS Table 7.1)
- FORWARD VISIBILITY
- EXISTING ROAD GULLY

THIS MAP IS REPRODUCED FROM ORDNANCE SURVEY MATERIAL WITH THE PERMISSION OF ORDNANCE SURVEY ON BEHALF OF THE CONTROLLER OF HER MAJESTY'S STATIONERY OFFICE. © CROWN COPYRIGHT AND MAY BE REPRODUCED BY ANY PERSONS WHOSE NAMES ARE NOT MENTIONED HEREIN. ANY REPRODUCTION IN WHOLE OR IN PART WITHOUT THE WRITTEN PERMISSION OF ORDNANCE SURVEY IS PROHIBITED AND MAY LEAD TO PROSECUTION OR CIVIL PROCEEDINGS. License No. 100010099

Rev.	Date	Description	By	Chk'd	App'd

Drawing Status: **FOR INFORMATION** Suitability: **S2**

**SNC-LAVALIN**  
 Member of the SNC-Lavalin Group

**ATKINS**

The Axis  
 10 Holliday Street  
 Birmingham  
 B1 1TF

Tel: +44 (0)1214 835000  
 Fax: +44 (0)1214 835252  
 www.atkinsglobal.com  
 © SNC-Lavalin (2020)

Client: **COVENTRY CITY COUNCIL**

Project Title: **CHELTENHAM CROFT OUTLINE PLANNING APPLICATION**

Drawing Title: **PROPOSED JUNCTION ACCESS**

Scale	Designed	Drawn	Checked	Authorised
1:100	AE	AE	PDE	PR
Original Size	Date	Date	Date	Date
A1	10.11.20	10.11.20	10.11.20	10.11.20

Drawing Number: **CHEL-ATK-HGN-CROFT-DR-D-0002** Revision: **P4**